





MMPH

INDUSTRIES®

Installation Guide BEE III Bracket Cradle Assembly

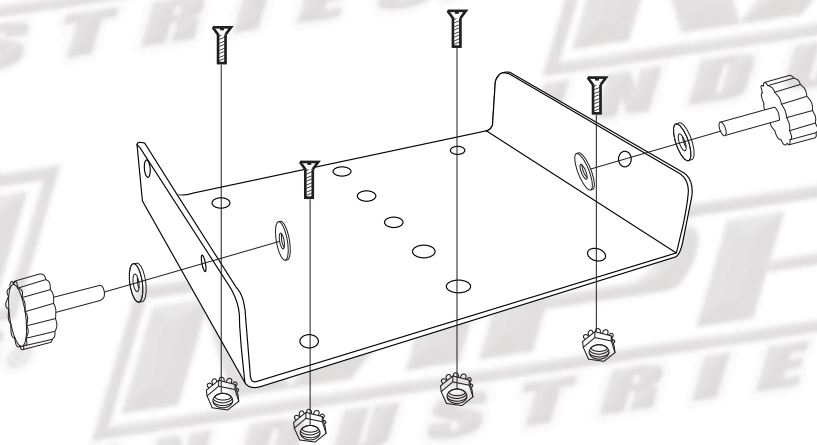
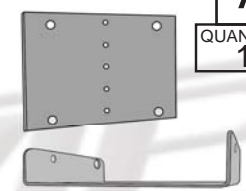
PT# ai.951389

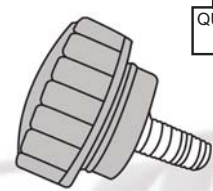
Installation Materials

<p>ai.951389</p> <p>Substructure 1</p>  <p>BEE III Bracket Cradle</p>	<p>910102</p> <p>A</p> <p>QUANTITY 1</p>  <p>Display Bracket</p>	<p>908338</p> <p>B</p> <p>QUANTITY 4</p>  <p>#4-40 KEP Nut</p>
	<p>908338</p> <p>C</p> <p>QUANTITY 4</p>  <p>#4-40x.25 Flat Head Screw</p>	<p>909094</p> <p>D</p> <p>QUANTITY 2</p>  <p>10-32 Stud Knob</p>
	<p>900092</p> <p>E</p> <p>QUANTITY 4</p>  <p>Flat Nylon Washer #10</p>	

MMPH

INDUSTRIES®

Installation Guide Ford Taurus Interceptor Center Dash Radar Bracket

PT# ai.951660

Installation Materials

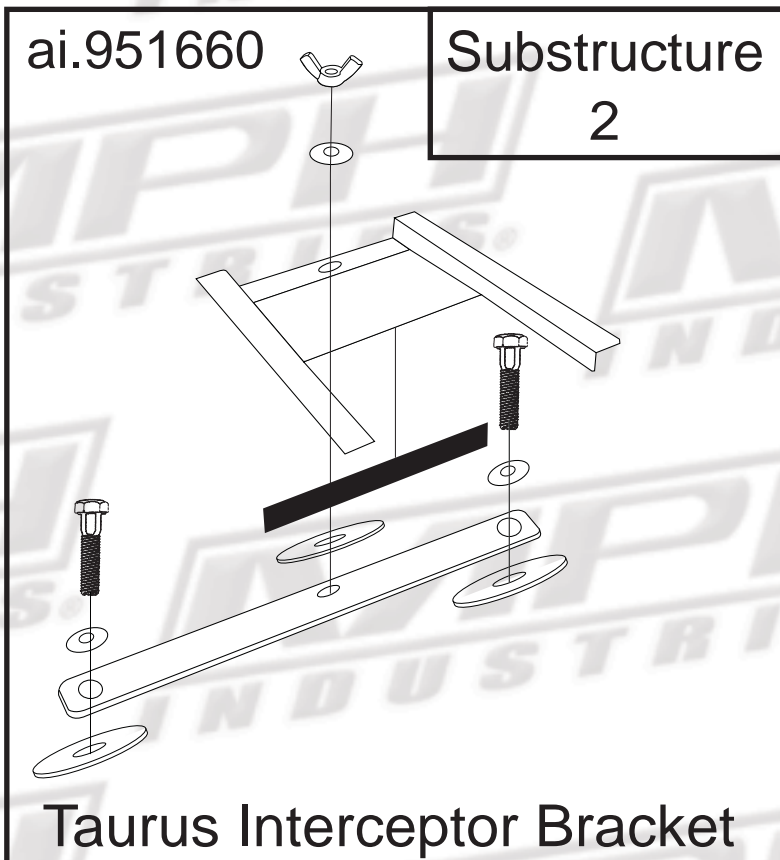

903787G01	F	910656G01	G
	QUANTITY 1		QUANTITY 1
Uni. Mounting Bracket		Radar Dash Bracket	

903405	H	903354	I	910658	J
	QUANTITY 4		QUANTITY 4		QUANTITY 2
6-32x.250 Screw		#6 Lock Tooth Washer		Hex Cap Screw	

900025	K	900024	L	903542	M
	QUANTITY 3		QUANTITY 1		QUANTITY 1
Disc Spring		Nylon Washer		Wing Nut	

620009	N	910653	O	
	QUANTITY 1		QUANTITY 2	
Scotch Foam		Fender Washer		Used ONLY with the Python 2

Installation Process

1

Place the Display Bracket (A.1) onto the Universal Mounting Bracket (F.2). Use Flat Head Screws (C.1) to secure the two brackets together. Lock tight with KEP Nut (B.1)

2

Take the Radar Dash Bracket (G.2) and place Nylon Washer (L.2) on the stud of the Radar Dash Bracket (G.2). Place the stud through of the center hole of the Universal Mounting Bracket (F.2). Secure with a Disc Spring (K.2) and a Wing Nut (M.2). Tighten.

3

Once built and tightened, take the Scotch Pad (N.2) and place it on the center bottom part of the Universal Mount Bracket (F.2).

4

Place the combined substructures onto the center of the dash tray. On the Radar Dash Bracket (G.2) place the Hex Cap Screws (J.2) through the outside holes of the bracket separated by a Disc Spring (K.2). A Fender Washer (O.2) will go through the Hex Cap Screws (J.2) and separate between the Radar Dash Bracket (G.2) and the dash tray of the car.

5

Place the radar unit onto the Display Bracket (A.2). Fit a Flat Nylon Washer (E.1) onto a Stud Knob (D.1). Place another Nylon Washer (E.1) between the radar unit and the Display Bracket (A.1). Repeat for other side.

6

When Finished, the Radar Bracket can be adjusted by loosening the Stud Knobs (D.1) and moving the radar unit in the direction preferred by the person.

7

BEE III Radar Cradle (ai.951389)
W/
Ford Taurus Interceptor
Center Dash Bracket (ai.951660)

ITEM	QUANTITY	PART NUMBER	DESCRIPTION
A	1	910102	Display Bracket
B	4	908338	#4-40 KEP Nut
C	4	903772	#4-40 Flat Hd. Screw
D	2	909094	10-32 Stud Knob
E	4	900092	Flat Nylon Washer #10

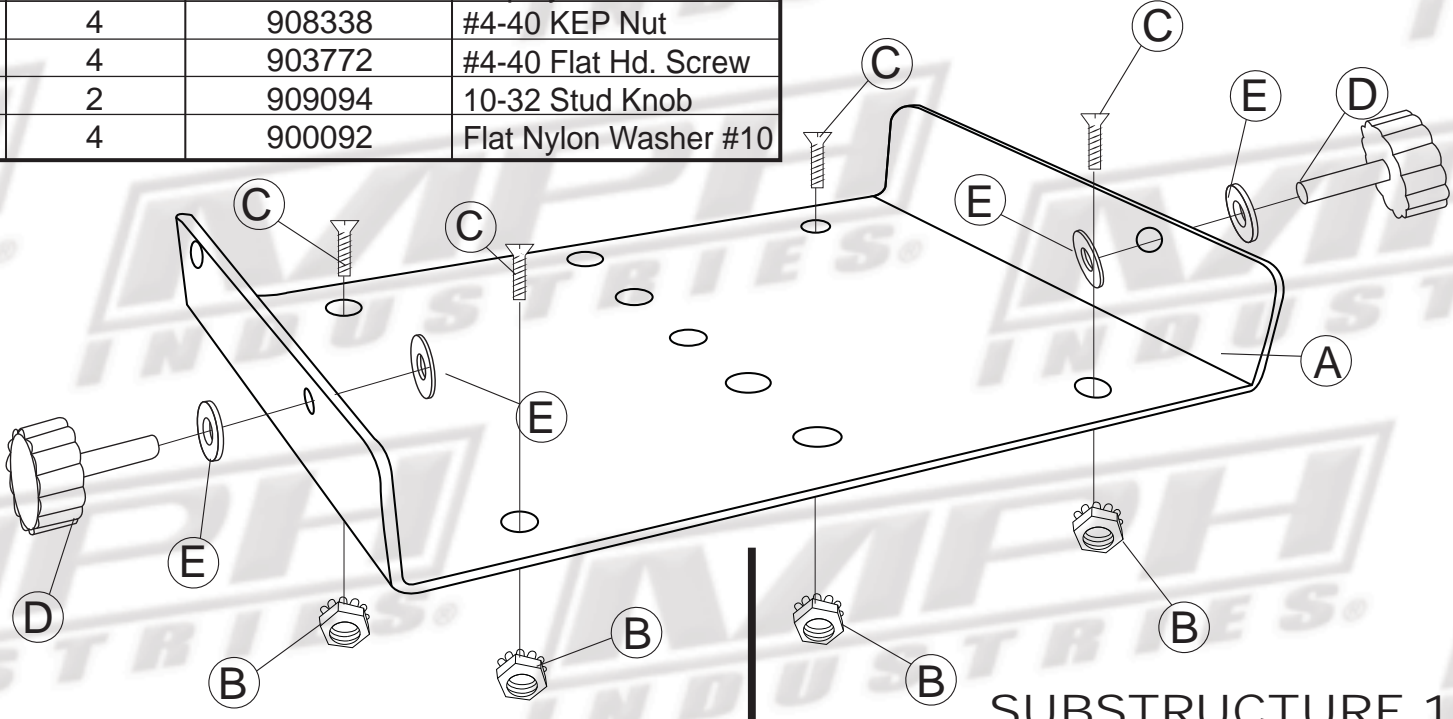

SUBSTRUCTURE 1

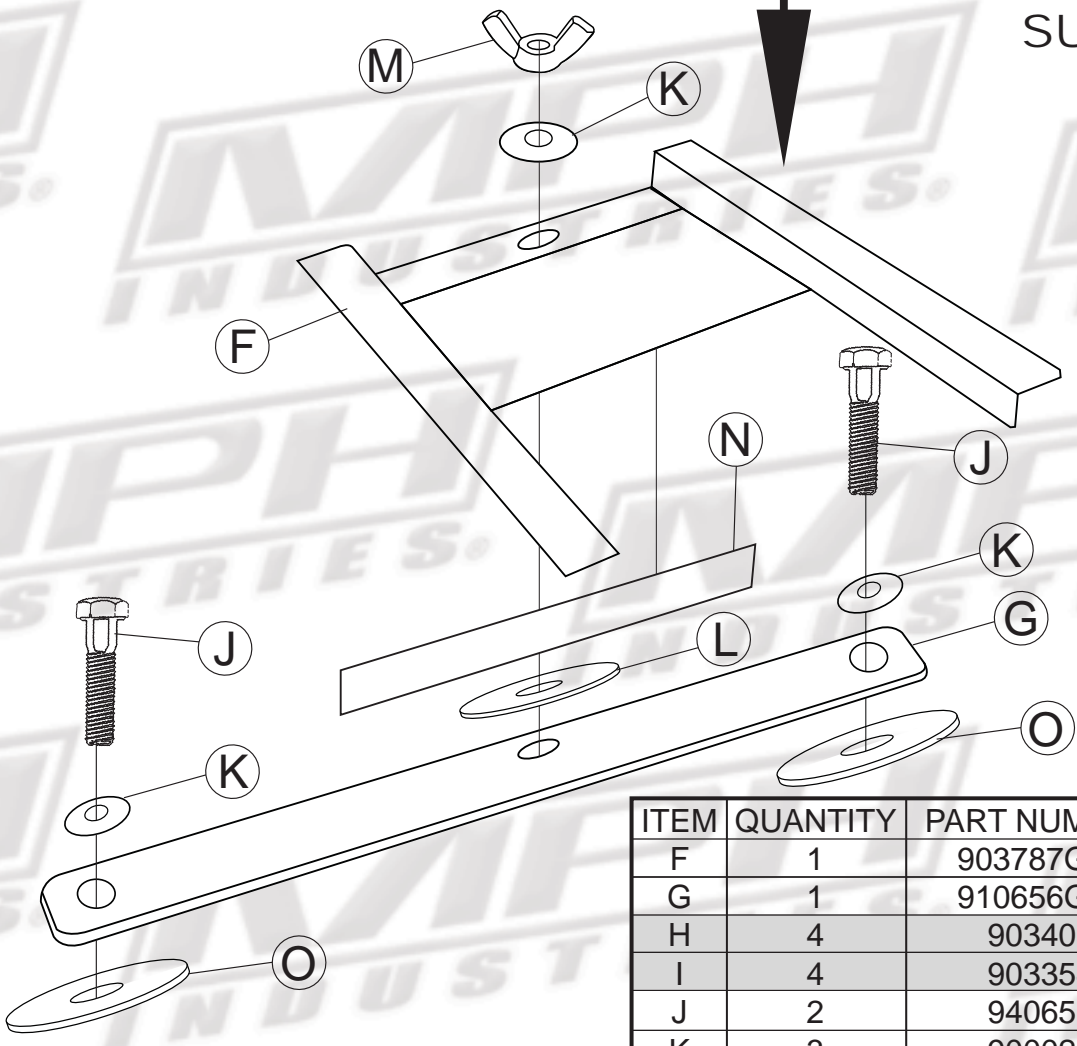

SUBSTRUCTURE 2

ITEM	QUANTITY	PART NUMBER	DESCRIPTION
F	1	903787G01	Univ. Mounting Bracket
G	1	910656G01	Radar Dash Bracket
H	4	903405	6-32x .25 Screw
I	4	903354	#6 Lock Tooth Washer
J	2	940658	Hex Cap Screw
K	3	900025	Disc Spring
L	1	900024	Nylon Washer
M	1	903542	Wing Nut
N	1	620009	Scotch Foam
O	2	910653	Fender Washer

